

**ROCKWOOL**
F I R E S A F E I N S U L A T I O N

Conlit[®] Hydrocarbon Firewall Slab

Hydrocarbon fire protection for bulkheads, decks and firewalls

Fires on offshore installations are categorised as being either hydrocarbon or cellulosic. Cellulosic fire conditions are typified by burning timber and upholstery (as may be found within accommodation areas). Hydrocarbon fire conditions are typified by burning oils and fuels (outside accommodation areas combustible materials will be predominantly hydrocarbons). Hydrocarbons burn far more fiercely than cellulosic materials and consequently require associated fire protection systems to be of substantially superior performance.

Conlit Hydrocarbon Firewall Slab has been engineered to meet the highest hydrocarbon (HC) fire requirements

Advantages

- Excellent fire protection and thermal insulation
- Acoustically absorbent
- Water repellent
- Easy to handle and install

Standards and approvals

Conlit Hydrocarbon Firewall Slab is approved by Lloyd's Register of Shipping for use in:

H60 and H120 bulkheads and decks

H60 and H120 Firewalls

Conforms to BS 3958-5 'Specification for bonded man-made mineral fibre slabs'.



Description

Dimensions

Standard size: 900 × 600 mm

Thicknesses: 30, 40, 50 and 65 mm

Finishes

Can be supplied with a reinforced aluminium foil facing.

Performance

Fire

Rated non-combustible.

Durability

Rockwool fire protection slabs will perform effectively throughout the lifetime of the host structure.

Water resistance

Rockwool mineral wool repels water. Moisture condensing from the air within Rockwool is less than 0.02% by volume at 95% rh. Where a vapour barrier is required Rockwool products can be supplied with a foil facing. It should be noted that foil faced Conlit Hydrocarbon Firewall Slab is a mandatory component of the Rockwool H120 Firewall system (see *Design details*, below).

Thermal conductivity

Mean temperature (°C)	Value (W/mK)
10	0.033
50	0.038
100	0.045
200	0.058
400	0.093

Environment

No CFCs, HFCs or HCFCs are used in the manufacture of Rockwool materials.

Design details

The diagrams opposite give typical details of Lloyd's Register of Shipping approved Systems.

Typical specifications

H60 or H120 decks/restricted bulkheads

The fire protection to decks/bulkheads to be Rockwool¹ Conlit Hydrocarbon Firewall Slab as supplied by Rockwool Limited, Pencoed, Bridgend, CF35 6NY, applied in 2 layers and secured to steel divisions and stiffeners with 3 mm (nom.) diameter welded steel pins and 38 mm (nom.) diameter spring steel washers at nominal 300 mm centres. The joints in adjacent layers of Slab to be staggered and the whole further supported by wire mesh. Excess pin length to be bent over.

¹ Insert 50 mm for H60 or 65 mm for H120 Fire Protection.

H60 or H120 firewalls

The fire protection to profiled steel firewalls to be 50 mm Rockwool Hydrocarbon Firewall Slab as supplied by Rockwool Limited, Pencoed, Bridgend, CF35 6NY, applied in² layers and secured with 3 mm (nom.) diameter welded steel pins and 38 mm (nom.) diameter spring steel washers at nominal 300 mm centres along trough; the troughs to be infilled solidly with the Slab. The underlying layer of Conlit Hydrocarbon Firewall Slab to be foil faced. The joints in adjacent layers of slab to be staggered and the whole further supported by wire mesh. Excess pin length to be bent over.

² Insert 2 layers for H60 or 3 layers for H120 Fire Protection.

Note Other approved Hydrocarbon fire protection systems available from Rockwool Limited include those used to provide protection to pipes, vessels and structural steel.

Deck and restricted bulkhead details

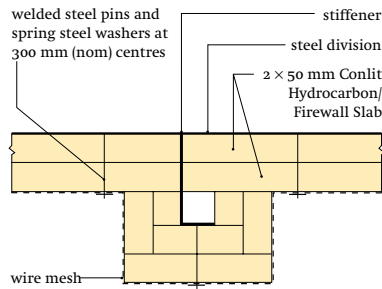

H60 Deck/H60 Restricted bulkhead

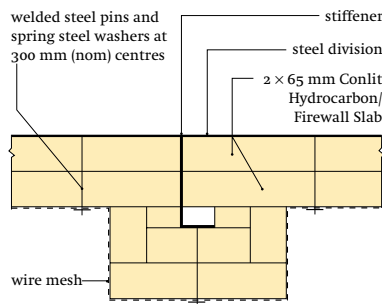

H120 Deck/H120 Restricted bulkhead

Firewall details

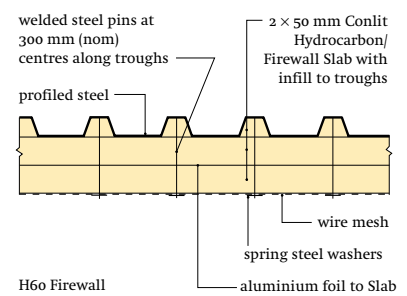

H60 Firewall

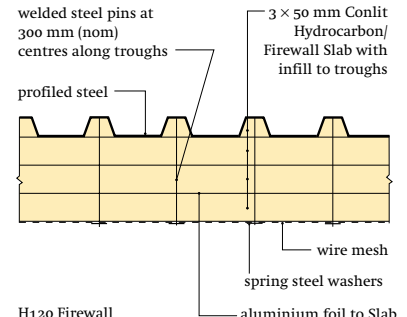

H120 Firewall

Under fire test conditions, the H120 Firewall detailed above surpassed hydrocarbon fire test requirements for in excess of 4 hours (at which time the test was discontinued).

Work on site

Handling and storage

Rockwool fire protection Slabs are light and easy to handle and fix. The slabs can be cut and shaped using a broad bladed knife or saw.

Maintenance

Once installed, Rockwool fire protection slabs should need no maintenance.

Health and safety

A COSHH Data sheet is available from Rockwool's Marketing Services Department.

Current HSE 'CHIP' Regulations and EU Directive 97/69/EC confirm that Rockwool fibres are not classified as a possible carcinogen.

Technical Helpline

Technical advice is available from the Rockwool Industrial Helpline on 01656 868130.

Rockwool Limited reserves the right to alter or amend the specification of products without notice as our policy is one of constant improvement.

The information contained in this data sheet is believed to be correct at the date of publication. Whilst Rockwool will endeavour to keep its publications up to date, readers will appreciate that between publications there may be pertinent changes in the law, or other developments affecting the accuracy of the information contained in this data sheet.

The above applications do not necessarily represent an exhaustive list of applications for Conlit Hydrocarbon Firewall Slab. Rockwool Limited does not accept responsibility for the consequences of using Conlit Hydrocarbon Firewall Slab in applications different from those described above. Expert advice should be sought where such different applications are contemplated, or where the extent of any listed application is in doubt.

WILHAMS

Wilhams Insulation Far East Sdn Bhd (340166M)
15 & 17 Jalan U5/23, Seksyen U5,
Mah Sing Integrated Industrial Park
40150 Shah Alam, Selangor Darul Ehsan, Malaysia
Tel: 603-7846 6728 Fax: 603-7846 6540
E-mail: wife@tm.net.my